



Heinrich Walser
Saffretta Ferienwohnungen
Kirchgasse 6
6562 Mathon – Ischgl
Österreich
info@saffretta.at
www.saffretta.at



Thank you for your interest in making holidays in our region. We would like to introduce ourselves to you and make you a special offer. Why not spend wonderful holidays in Ischgl - Mathon? Read more about our offer here.

Our house provides 4 holiday apartments which we would be pleased to let to you. Each apartment comprises two spacious double bed rooms and an open plan kitchen. Following the traditional building style of our country, we have used a lot of timber for the interior construction since we believe that timber greatly enhances the well-being and comfort of our guests. Each apartment provides two shower/WC-units thus guaranteeing best comfort for our guests.

Kitchens:

- 2,70 m long, stove with baking oven, refrigerator with freezing compartment, wash basin, dish washer, a coffee machine, electric kettle, microwave
- TV-set with satellite and W-LAN
- corner seat with table to at least 6 persons.

Additionally, sufficient tableware and cutlery as well as bedclothes etc. are provided. There is enough space for up to two additional beds in each apartment. Sufficient parking facilities are also available.

Anybody who has experienced the hustle and bustle of Ischgl will appreciate the quiet position of our house in the village of Mathon, a district of Ischgl (4 km distance). Of course, as a guest to Mathon you will benefit from the same discounts (e.g. for the skiing passes) as the guests to Ischgl. The bus station is directly in front of our house.

Our house is situated in a sunny position in the village centre of Mathon and provides a direct view to the other side of the valley where a feeding ground for local game animals is located.

We would be pleased to welcome you in our house.

Apartment Nr. 1

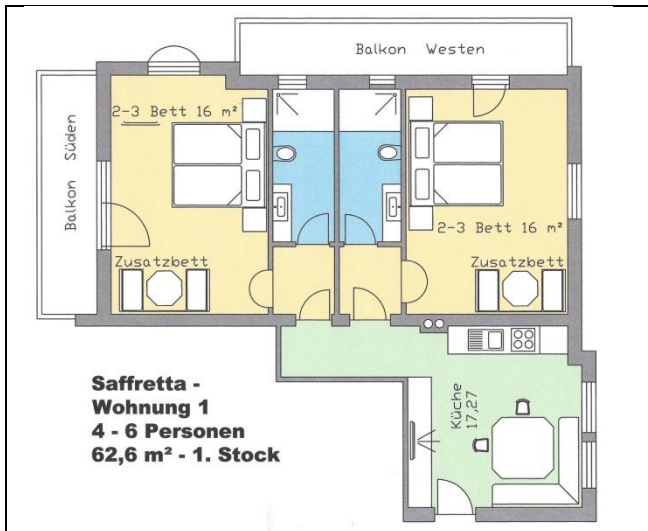

Apartment Nr. 2

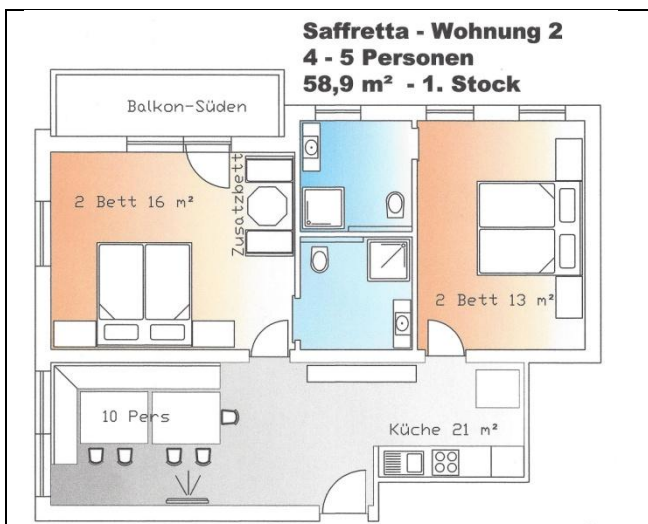

Apartment Nr. 4

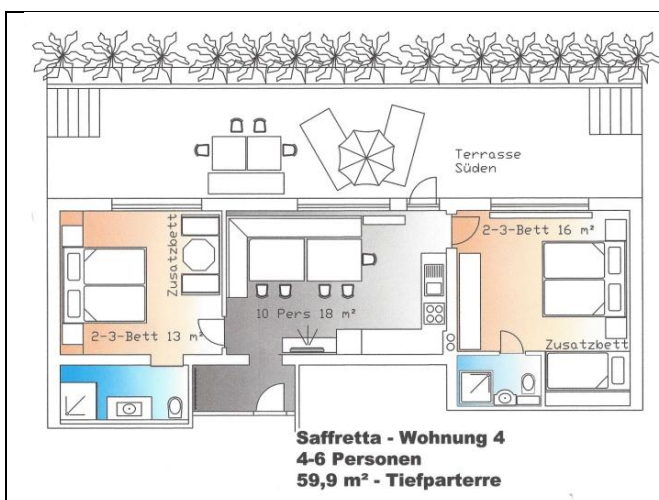
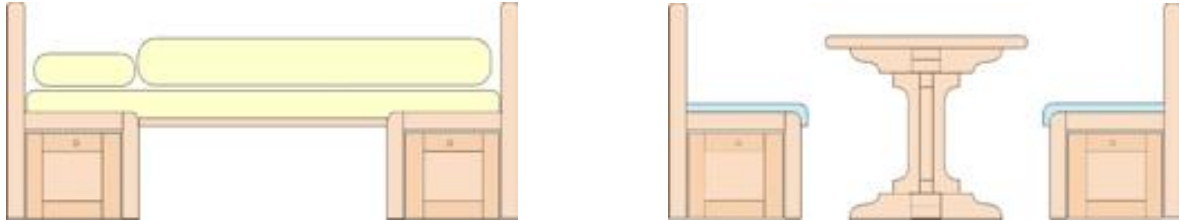

table and bench set - extra sleeping capacity

Option 1: Two benches with an octagonal table

Optin 2: The benches are arranged in a way that the upholstery can be removed and a slatted frame be put on them. A mattress (standard size) on the slatted frame provides extra sleeping capacity.



Mathon

MATHON, Ischgl's little sister. The village of Mathon is located between the popular ski resorts of Ischgl and Galtür along the Silvretta-Hochalpenstraße pass road. The valley stations of the Silvretta-Samnaun ski arena in Ischgl, a ski area guaranteeing perfect snow conditions throughout the winter season, are only a 7 minute drive away. A regular bus service runs directly to the cableways (free of charge with skiing passes) and spares you from a tiring search for parking facilities.

MATHON is a small village with 350 inhabitants which has successfully managed to preserve its traditional rural characteristics. The village disposes of all important facilities (post office, bank, bakery, 6 restaurants, a farm museum and a small alpine zoo). The cross-country ski run along the village is one of the most beautiful ones in the Tyrolean Alps.

MATHON is surrounded by the huge ski touring and hiking region of the Ferwall and Silvretta mountains. The splendid Paznaun mountain region offers its visitors all kinds of possibilities for varied and sportive holidays both in the summer and winter.

MATHON is the ideal starting point for wonderful hiking tours to the mountain pastures and alpine huts up to the glaciers. A heated outdoor swimming pool with a big slide on the outskirts of a wood, 4 tennis halls, 4 outdoor tennis courts, riding stables, a shooting stand as well as a small alpine zoo are within easy reach. In addition, both Ischgl and Galtür have a sports centre providing an indoor swimming pool, squash courts, tennis halls, bowling alleys, a sauna and solarium etc. 5 km to Galtür - 4 km to Ischgl - a regular bus service runs directly to the cableway stations.

Where is Ischgl?

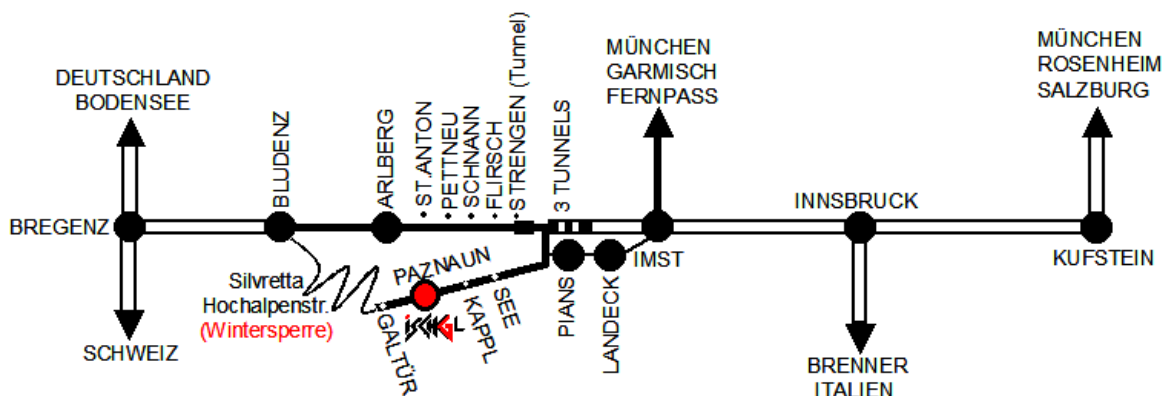

Some more information you find on our homepage: www.saffretta.at